

Type:

Job:

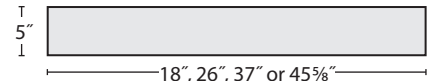

A sharper, Euro version of our P3900.

Four decades after launching our Sky Oculus P3900 we launched a sleeker, more bold and modern big round. Often specified in one of our twenty one premium colors (no set-up fee).

P4030-LED35-SO-VWA-D1
 11889 Delivered Lumens
 113 Watts
 106 lm/w
 Test #L031511001

**LUMEN OUTPUT:
Direct (D1)**

		LO	MO	SO	HO
18"	lm	950	1650	1950	2150
	w	19	33	39	47
2'	lm	2100	3150	3900	5300
	w	35	54	67	97
3'	lm	5800	9100	11889	17700
	w	56	87	113	177
4'	lm	9200	11500	18200	28000
	w	88	110	174	281



Lumen output may vary +/- 5%
 3500K used for lm/ft estimates above
 4000K +2% llf, 3000K -2%, 2700K -4%
 -10% LLF for 90 CRI (4K, 3500K and 3K)

See LED Details PDF for more info

SERIES	LED COLOR	OUTPUT	SHIELDING	COLOR/FINISH	DISTRIBUTION	CIRCUITING	VOLTAGE	MOUNTING	CEILING SYSTEMS	DRIVERS	OPTIONS
P4018 18" Dia. (11 lbs)	LED27 2700K (90CRI)	LO Low MO Medium	FWA Flat White Acrylic Lens (Standard)	TMW Textured Matte White (Standard)	D1 Direct	SC Single Circuit	UNV (120- 277)	SUR Surface Mount	X1 T-Bar 1 1/16" or 3/16" Exposed (Standard) Consult factory for 3/8" Tegular	ND Non-Dimming, Osram DM10 0-10v, 10% Dimming (Standard) DM01 0-10v, 1% Dimming STEP Step Dimming, 100-50-Off, Osram	EML Emergency Battery, Low (P4018: 400; P4020: 500; P4030 & P4040: 900 deliv- ered lumens)
P4020 2" Dia. (22 lbs)	LED3 3000K	SO Standard	VWA Convex White Acrylic Lens (1" Max drop)	YGW Gloss White	D9 Semi- Direct (20-30% uplight, NA Surface) To specify more or less Uplight, see Output. NOTE: NA - 18", 2" D9 DC LO	DC Dual Circuit (Two feeds required, D9 only)	347 (Emer- gency battery requires a Step Down trans- former)	MPCA48", 96" or 144" Monopoint Mounting (For 18" & 2' - 9" min. from fixt. to ceiling, for 3' & 4' fixt. 18" from fixt. to ceiling)	X3 Hard Ceiling X6 Slot Grid or Interlude	NOTE: Lumens and watts per foot may differ for STEP drivers, consult factory LDE5 5%, Lutron (Ecosystem) LDE1 1%, Lutron (Soft Fade to Black, Ecosystem) LTE 1% Forward Phase, 2 Wire, Lutron (120V only) ECO 1% 0-10v, EldoLED ECDA 1% DALI, EldoLED SOLO 0.1% 0-10v, EldoLED (Dim to Dark) SODA 0.1% DALI, EldoLED (Dim to Dark)	EMH Emergency Battery, High (NA - 18" & 2', P4030 & P4040: 1250 delivered lumens) IBC Insulated Braided Cord PRUBIN Meticulous Binning and Labeling Every LED Board Within a 2-Step MacAd- ams Ellipse
P4030 3" Dia. (35 lbs)	LED35 3500K	PROG Program- mable Light Output (Specify desired lm or w/ fixture)		Y Premium Color				CA48", 96" or 144" Aircraft Cable (Adjustable)			
P4040 4" Dia. (50 lbs)	LED4 4000K			CC Custom Color				SSC Top- Swivel Stem Mount for Hard Ceilings (Specify length in inches) NOTE: P4018 SUR or MPCA only			
	LED3- 90 90CRI	NOTES: Specify separate output Down / Up if desired eg. LO/ HO (Low Down, High Up) Consult factory for uplight lumen output P4018: NA LO or MO Uplight unless Downlight is same output level		NOTES: Top plate is always Gloss White for optical performance. All canopies are painted the same color as the fixture. Consult factory to specify							
	LED35- 90 90CRI										
	LED4- 90 90CRI										



P4000 Sky | Pendant & Surface



PRUDENTIAL LTG.

PRULITE.COM 213.746.0360

D1 DIRECT

P4030-LED35-SO-FWA-D1

11889 Delivered Lumens
113 Watts
106 lm/w
Test #L031511001

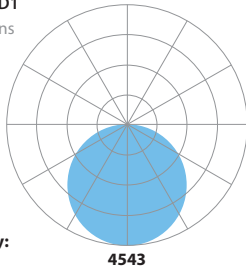

Zonal Lumen Summary: 0-90 = 100%

4543

Vertical Angle	0°	25°	45°	65°	90°
0°	4543	4543	4543	4543	4543
5°	4524	4524	4524	4524	4524
15°	4353	4353	4353	4353	4353
25°	4034	4034	4034	4034	4034
35°	3584	3584	3584	3584	3584
45°	2935	2935	2935	2935	2935
55°	2081	2081	2081	2081	2081
65°	1282	1282	1282	1282	1282
75°	527	527	527	527	527
85°	126	126	126	126	126
90°	0	0	0	0	0

Luminance Chart:

Angle	0°	45°	90°
45°	6487	6487	6487
55°	5670	5670	5670
65°	4741	4741	4741
75°	3182	3182	3182
85°	2259	2259	2259

D9 SEMI-DIRECT

P4030-LED4-LO-FWA-D9

6140 Delivered Lumens
59 Watts
104 lm/w
Test #L041411809

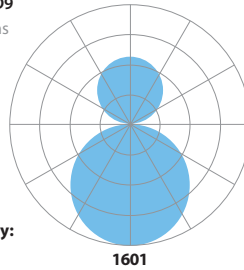

Zonal Lumen Summary: 0-90 = 67% 90-180 = 33%

1601

Vertical Angle	0°	25°	45°	65°	90°
0°	1601	1601	1601	1601	1601
5°	1591	1591	1591	1591	1591
15°	1528	1528	1528	1528	1528
25°	1409	1409	1409	1409	1409
35°	1243	1243	1243	1243	1243
45°	1039	1039	1039	1039	1039
55°	810	810	810	810	810
65°	583	583	583	583	583
75°	339	339	339	339	339
85°	119	119	119	119	119
90°	0	0	0	0	0
95°	40	35	31	30	33
115°	141	151	178	173	169
125°	256	219	223	263	258
135°	351	353	357	358	354
145°	445	446	449	450	446
155°	529	529	531	531	528
165°	592	592	592	591	589
175°	626	629	629	624	622
180°	629	629	629	629	629

LUMEN OUTPUT: Direct/Indirect (D9)

D1 ON
PREVIOUS
PAGE

	LO	MO	SO	HO	UPLIGHT	
18":	lm	1765	3300	3500	4200	30%
	w	23	42	47	58	
2':	lm	3750	5250	6550	9350	14%
	w	43	59	76	110	
3':	lm	5570	8880	11300	16950	19%
	w	60	95	125	194	
4':	lm	9740	14300	19190	28250	25%
	w	97	142	193	296	

LUMEN MAINTENANCE

Designed to last with cool running mid-power LEDs projected to maintain 90% (L90) of their initial output for 100,000 hours (at HO), and L70 exceeding 150,000 hours.

LED SYSTEM LED modules and drivers are field replaceable.

PROG (OPTIONAL) Programmable light output. Specify desired lumens or watts per fixture.

BINNING Standard binning (all Prudential LED boards) includes testing at the chip level and board integration to provide consistent color temperature within a 3-step MacAdams ellipse, with +/- 5% lumen output range and +/- .004 Duv.

PRUBIN™ (OPTIONAL) Prudential Ltg's exclusive 'job binning' method that ensures color temperature consistency across all luminaires on a project. Meticulously testing and labeling **EVERY LED BOARD** to +/- 25 lumens, +/- 50k CCT and +/- .004 Duv — while also separating positive from negative — allows us to match color, hue and intensity throughout a project and provides a consistent color temperature within a 2-step MacAdams ellipse

LABELS

ETL damp labeled and I.B.E.W. manufactured.

ELECTRICAL

Must specify LED dimming controls. LED fixtures have constant current driver(s) with less than 20% THD when loaded to a minimum of 60%. Drivers sink a maximum of 6mA per driver. DM10 LED drivers are 0-10V dimmable and are compatible with most 0-10V wall slide dimmers and direct 0-10V analog signal dimmers. Max driver size 2.38" w x 1.5" h.

CONSTRUCTION

Housing Extruded aluminum, rolled and welded, >25% PC recycled, 100% recyclable

Lens Convex (subtle drop mitigates lamp image) or flat acrylic, 100% recyclable

MOUNTING

Surface or suspended by straight aircraft cables, top-swivel stems

WARRANTY

Single-source, 5 year limited warranty covers standard components and construction.



Prudential Ltg. reserves the right to change design specifications or materials without notice. Please visit prulite.com for most current data.
© 2014 All rights reserved - All products manufactured at: Prudential Ltg. 1774 E. 21st Street, Los Angeles, CA 90058

Sky Oculus Series

2

11-28-2018



YSW – Seashell White (Matte)	YCH – Champagne (Metallic)
YSL – Silver (Metallic)	YPE – Pewter (Matte)
YRG – Rain Grey (Gloss)	YSTM – Storm Grey (Matte)
YBK – Black (Matte)	YBB – Black (Semi Gloss)
YSKM – Sky (Matte)	YMB – Military Blue (Matte)
YIB – Interstate Blue (Matte)	YSAM – Sapphire (Matte)
YFGM – Forest Green (Matte)	YBR – Bronze (Matte)
YBY – Boysenberry (Matte)	YSRM – Sunset Red (Matte)
YOR – Orange (Matte)	YDAM – Daffodil (Matte)



Client | Mercedes Benz Architect | Interior Architects

MOUNTING LOCATIONS

MPCA, CAX & SUR

- ◆ ¼" Mounting hole
- ⊕ 7/8" Wiring K.O.

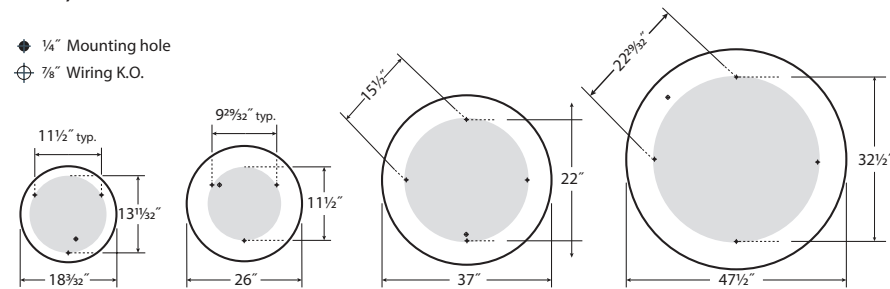

STEM

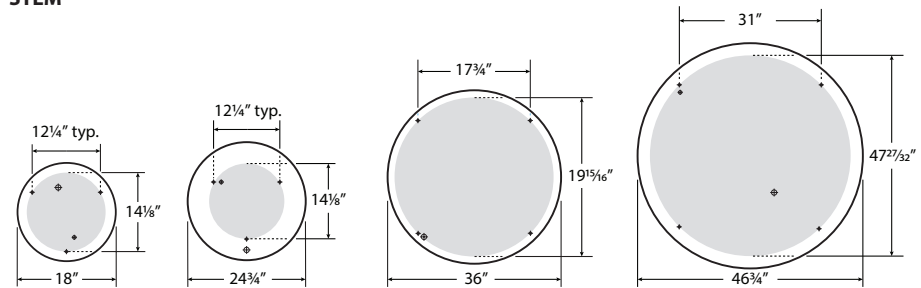

MOUNTING CABLES

MPCA: 18" & 2' - (1) 3-Way Cable
3' & 4' - (1) 4-Way Cable

CA:
2' - (3) Straight cables (18" X3 N/A)
3' & 4' - (4) Straight cables

SSC: 2' - 3 Stems
3' & 4' - 4 Stems

